

The Seakeeper 35 is designed to achieve 70 to 90% roll reduction on boats up to 140 tons. Multiple units can be fitted for larger boats. The Seakeeper 35 requires only modest electrical power, has no outside appendages, and can be installed off centerline, if necessary. Its computerized control and vacuum technology make it the first truly practical, and only modern, anti-roll gyro.



SPECIFICATIONS

| | |
|---|--|
| Rated Speed | 5,150 RPM |
| Angular Momentum at Rated RPM | 35,000 N-M-S |
| Anti-Rolling Torque at Rated RPM | 73,000 N-M |
| Spool-up Time to Rated RPM | 65 minutes (5,150 RPM) |
| Spool-up Time to Stabilization | 45 minutes (4,380 RPM) |
| Spool-up Power | |
| AC Motor: | 5000 Watts Max |
| DC Control: | 240 Watts |
| Operating Power | |
| AC Motor (sea state dependent): | 2000-5000 Watts |
| DC Control: | 240 Watts |
| AC Input Voltage: | 208-230 VAC (+/- 10%), 50/60 Hz, Single Phase |
| DC Input Voltage: | 24 VDC @ 10 Amps |
| Sea Water Supply to Heat Exchanger | 53 LPM (14 GPM) maximum 38 LPM (10 GPM) minimum |
| Maximum Ambient Air Temperature | 0°-60° C (32°-140° F) |
| Weight | 1778 kg (3920 lbs) bolt-in installation |
| Gyro Dimensions | Length x Width x Height 1.38 L x 1.42 W x 1.11 H (meters) 54.3 L x 55.9 W x 43.5 H (inches) |
| Noise Output | At full operating RPM, steady state noise measured in the factory at a 1 meter distance measures 72-74 dBC (sound levels may be higher during spool-up). |

PORT VIEW

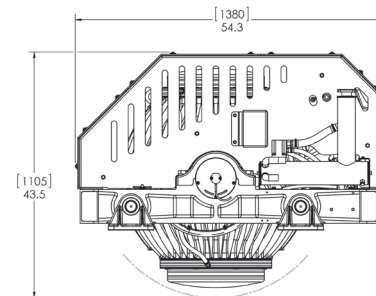

FRONT VIEW

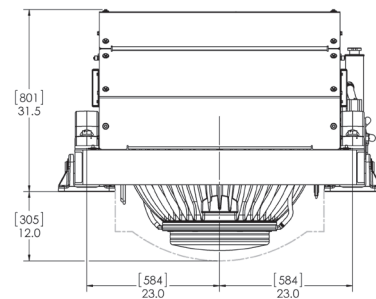

TOP VIEW

